

Section 13A

Wheels

Axles and Hardware	16-20
Hub Parts & Caps	6-15
Rims	2
Spokes	4-5
Tubes	3
Wheels	7-10,13-14

For our complete selection of tires see
Preston Cycle's Twin Cam Evolution and
Sportster Catalogue.

Chrome Rims

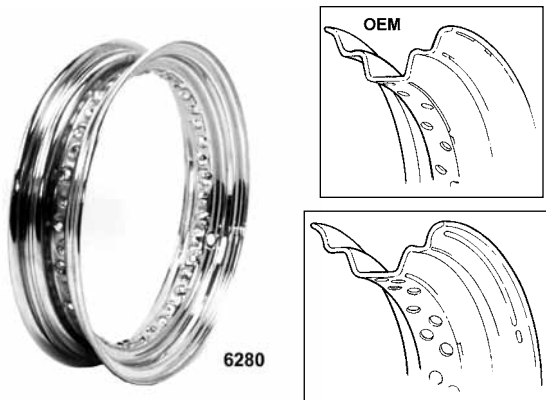

16" OEM Factory Style Drop Center Rims "A"

16" Original drop centre rim design with deep indent for safety beads. Chrome rims have 40 spoke holes.

PCP	Width	Finish	Description
6280	3.0	Chrome	As OEM w/large hole
70735	3.0	Black powdercoat	As OEM w/large hole
70752	3.0	Chrome	As OEM w/small hole
70753	4.0	Chrome	As OEM w/large hole

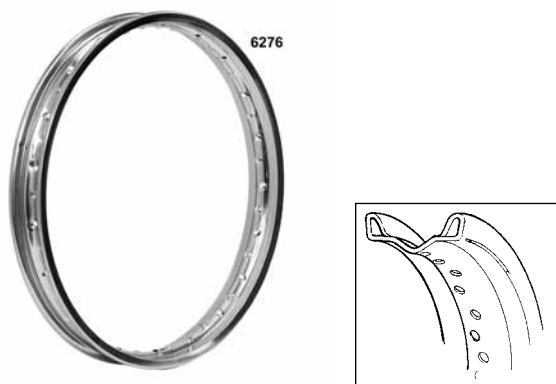

Conventional Chrome Rims "B" style

This type is flat or English style. It will fit front tires only, available in the following sizes.

PCP	Diameter	Width (40 Spoke Holes)
6276	21"	1.85"
70765	19"	2.15" (for 3.50-4.00)
70740	19"	XL Front 1952-63 (replica)

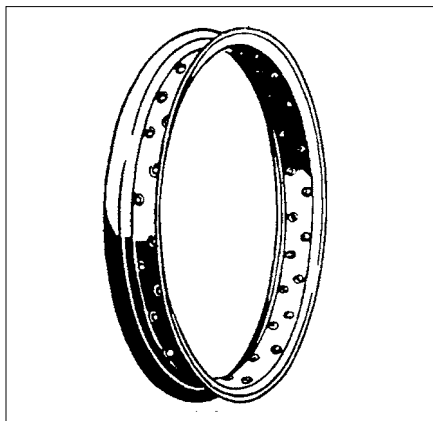

18" Steel Wheel Rim

PCP	OEM	Description
70736	43002-30B	45 Front, black
70737	43003-30C	45 Front, chrome
70738	43004-30B	All rear, black



OEM Factory Style Front Chrome Rim "D"

2.50" x 19" drop-centre 40 hole front rim with safety bead. OEM 43001-79 and 43018-73.
6278 19" drop centre (Taiwan)



Chrome Steel Wheel Rims

Drop centre style with rolled edges on 19" & 21" with high quality chrome plating. Features OEM style spoke dimple pattern and rim width for easy lacing and truing.

PCP	Size
70720	19" x 2.5" (DC) for 325-350 tire (43001-79)
70721	21" x 2.15" (43662-80B)



Black Steel Rims

Replica black powder coat rim with conventional bead construction. Measures 18" x 3.15" and 2.0" bead width. Fits front or rear EL 1936-40, and FL 1941-44.

70766



21" Drop Centre Rim "E"

Chrome plated rim with rolled edge as the H-D 21" wheel.

6277 43662-80B

Inner Tubes



Rim Strips

Heavy, thick, rubber rim strips that offer maximum protection for any size inner tube. Sold in packs of 10.

PCP	OEM	Size	Stem Location
3519	40575-77	16"	Side
3521	40576-77	18"	Centre
3523	40577-77	19"	Centre
3525	40578-80	21"	Centre
3527		16"	Centre



Chrome Valve Stem Cover

Chrome cover for inner tube valve stems. Sold as 5 pack.

- 2452 Rubber valve stem type (flared)
- 2453 Steel valve stem type (bullet)



3491

3492

Heavy Duty Tubes

Inner tubes are available for all types and sizes of tires. Butyl rubber for good air retention, carefully molded for uniformity and precision quality to provide for the finest service, long wear and security. Complete with metal valve.

PCP	Fits
3490	500/510 x 16MAG TR4—Metal Centre Valve
3491	500/510 x 16 HD TR15—Rubber Offset Valve
3492	500/510 x 16 HD TR6—Metal Offset Valve
3496	350/400 x 18 TR6
3497	400/450 x 18 TR6
3504	275/300 x 19 TR6
3505	325/350 x 19 TR6
3506	350/400 x 19 TR6
3507	275/300 x 21 TR6
3508	325/350 x 21 TR6



TR-6 VALVE
STEM



TR-15 VALVE
STEM

Chrome Plated Brass Valve Stem Caps

Designed to completely cover threads on steel stems. Offered in two lengths with chrome plated brass lock nuts. Each kit has two covers and two nuts.

- 72194 Medium length
- 72210 Long length



Chrome Steel Wheel Balance Weights

For use with spoke wheels. Sold in 10 packs.

PCP	Oz.
73622	1/2
73645	3/4
73683	1

Maltese Cross Valve Stem Cover

Matte black finish with raised white border.

- 44140 Pair



Skull Valve Stem Cover

Chrome with black eyes

- 44081 Pair

Spokes

Spoke Sets From Preston Cycle

We are able to offer a full selection of top quality chromed carbon-steel, polished or chromed stainless steel spoke sets. All our spoke sets feature 6/8 guage construction, and our polished stainless steel sets have spokes and nipples made from different types of stainless material to minimize their seizing to each other. We do suggest the use of anti-seize compound on stainless steel spoke sets.

Spoke Buying Guide

We show you the variety of stock and custom rims available from Preston Cycle for custom wheel building. Using our illustrations will help you determine which parts you have and then assist you to the spoke set you need. For example; if you have an aluminum 1978-83 FX model front hub, and you want to lace it with chrome steel spokes to the 21" drop centre rim from an FXWG (OEM 43662-80B or PC# **6277**) which is shown in illustration "A", then you would need to use a PC# **925** spoke set. The rim illustration shows the basic rim shape, and the position of the spoke holes in relation to each other.



Diamond and Twirled Spokes

Chrome Diamond	Chrome Twirled	Stainless Twisted	Use
3714	3710	43700	16" DC (F & R) "A"
3716	3712	43702	21" DC/steel Wide Glide hub "B & E"



Stainless Steel Twisted 16" Steel Spokes

A set of stainless steel spokes for 16" drop center rims. A new style of twist similar to our "Twirled" spokes.

43700 Set of 40 spokes and nipples



6/8 Gauge Nipple Set

Sold in packs of 40 to fit our spoke sets.

- 43096** Chrome standard
- 43097** As above stainless
- 43098** Chrome extended
- 43099** As above stainless

Note: When PC spoke kits are laced to 19" OEM #43001-79 rims PCP 43098 extended chrome spoke nipples must be used as the inside diameter of this rim is larger than others.



Deluxe Spoke Wrench

Rowe spoke wrench to fit spoke nipples, sized one to six.

5849

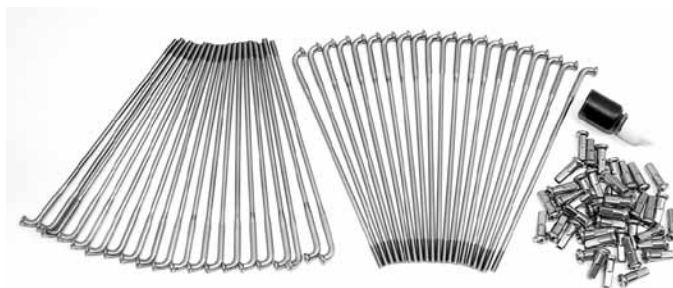

S.S. Buchanan 16" Spokes

43714 For use with Sun rims

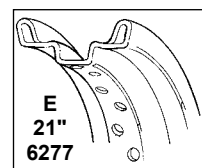
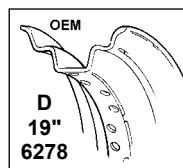
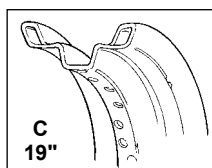
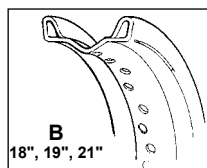
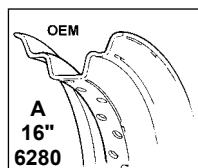

Spokes

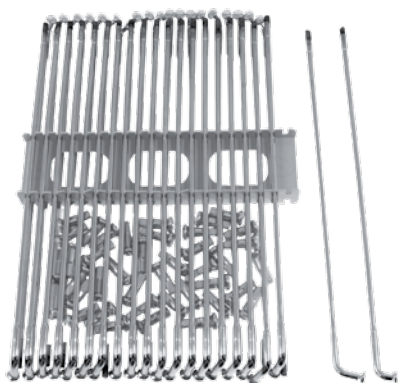

Replacement Spoke Set

Heavy duty 6-8 wire gauge spoke set for all twins. Available in either chrome plated with chrome nipples or stainless with stainless nipples. Complete sets of 40 spokes and nipples.

NOTE: Use hub illustrations to select proper spoke sets. Note spokes available in chrome or full stainless.

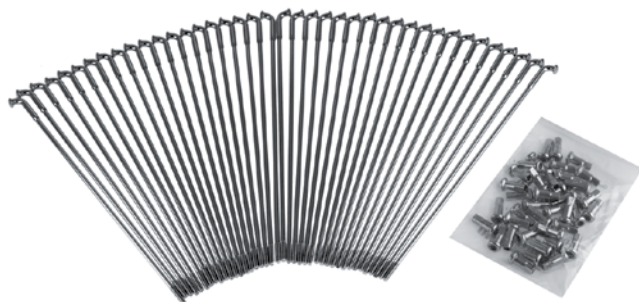

Stock Spoke Sets for DC Rim

- 43712** 16" zinc spoke set 1936-04 (43032-40C)
- 43717** 16" cad plated set 1936-on
- 43711** 18" cad plated set
- 43715** 21" spoke set (43239-05)

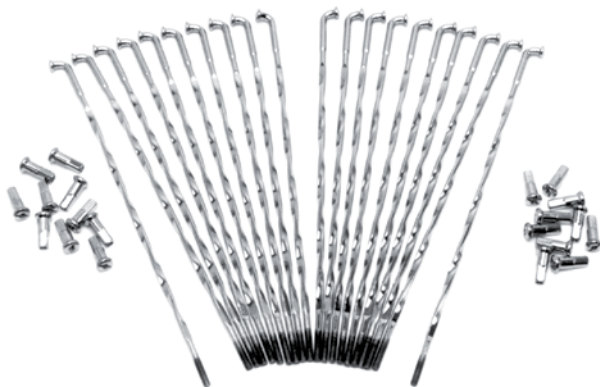

Chromed Steel 16" Twisted Spokes

40 chromed steel spokes and nipples for 16" drop center rims. A new style of twist similar to our "Twirled" spokes.

- 43704** Set for 16" rims
- 43705** Set for 21" rims (Steel hubs)

Single Flange

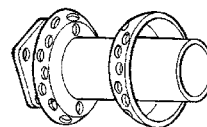

Double Flange 1973-86

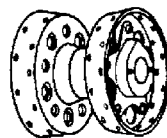
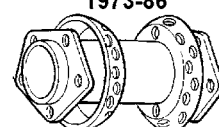

Star Hub 1937-66

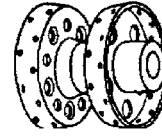

Mid-Star 1967-72

Spokes for Spool Hub

Chrome	Stainless	Rim"	Rim Type
-	3604	15	A
916	3605	16	A
924	3606	18	B
919	3607	19	B
924	3606	19	C & D
920	3608	21	B & E

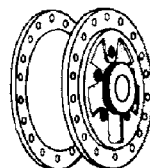

1973

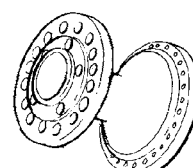

1978-on

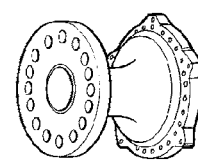

1974-77

Spokes for FX-XL Front Disc Brake Hub

Chrome	Stainless	Rim"	Rim Type
929	3609	19	C & D
926	3610	19	B
925	3611	21	B & E

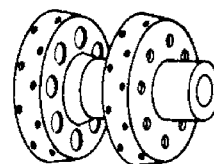

Spokes for Sportster Rear Wheel Spool Hub

Chrome	Stainless	Rim"	Rim Type
-	3604	15	A
916	3605	16	A
930	3612	18	A
924	3606	18	B

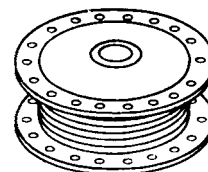

FX-XL Front Drum Hub

Chrome	Stainless	Rim"	Rim Type
447	5797	19	C & D
927		19	B
928	5799	21	B

1936-66 Wire Wheels

Star Hub Parts

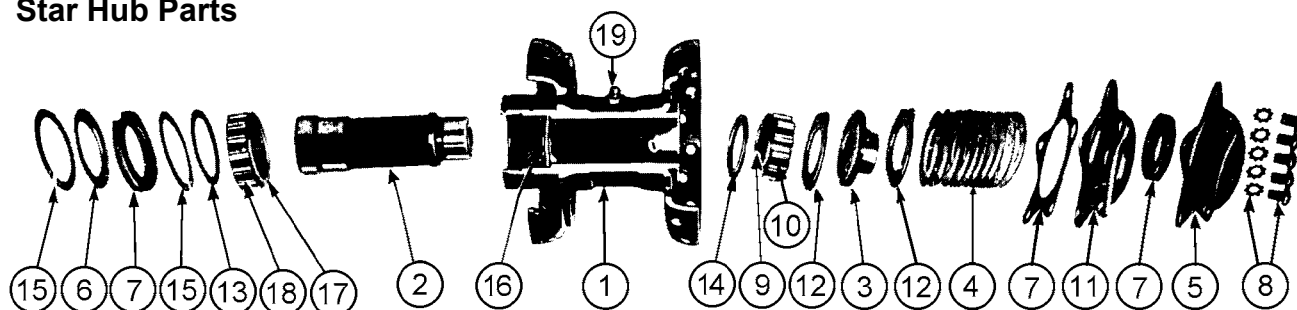

BT Wheel Hub & Parts 1936-66

	PCP	OEM	Description
1	43075	3958-36	Parkerized hub 1936-40, complete
	43073	3958-36	Black hub 1936-40, complete
	2511	43546-36B	Chrome hub 1941-66 complete
	43074	43540-36	Black hub 1941-66, complete
2	1307	43549-36	Rear Wheel Bearing Hub Sleeve 1936-66
3	2338	43556-36	Thrust Bearing Sleeve 1941-66
4	13581	43560-35	Wheel Adjusting Shims 1941-66 10 Pack
5	646	43566-35	Chrome Star Wheel Cover 1937-66
6	2512	43564-35	Wheel Hub Dust Shield 1936-66
7	2340		Wheel Gasket Kit 1941-66
	79147	43576-36	Wheel bearing cover 1935-66 (10)
8	1166		Chrome Star Wheel Screws for wheel 1936-66
	1719		Chrome Star Wheel Acorn Screws & Nuts for 1 wheel 1936-66
9	2513	9220	Right Rollers STD. Set of 12
	2514	9221	Right Rollers +.0002 Set of 12
	2515	9222	Right Rollers +.0004 Set of 12
	2516	9223	Right Rollers +.0006 Set of 12
	2517	9224	Right Rollers +.0008 Set of 12
	2518	9225	Right Rollers +.001 Set of 12

	PCP	OEM	Description
10	10729	24721-30	Right Side Roller Retainer 1941-66
11	3300	43574-35	Inner Wheel Hub Cover 1936-66
12	3301	43563-35	Thrust Washer 1941-66
13	3302	43558-39	Brake Side Washer 1936-66 (5 pk)
14	3303	43552-39	Wheel Spacer 1936-66
15	11087	43554-35	Wheel Thrust washer lock ring 1936-66 (10 pack)
16	2346	43561-39	Bearing Collar
17	10732	43578-35	Brake Side Roller Retainer 1941-66
18	2519	9220	Left Rollers STD Set of 14
	2520	9221	Left Rollers +.0002 Set of 14
	2521	9222	Left Rollers +.0004 Set of 14
	2522	9223	Left Rollers +.0006 Set of 14
	2523	9224	Left Rollers +.0008 Set of 14
	2524	9225	Left Rollers +.001 Set of 14
19	10511	9851	Grease Fitting (10 pk)

Grease Fitting

Stock type grease fitting for all models 1941-up, use on swing arm wheel hubs, seat post, brake parts. Replaces 9851 zinc finish.

10511 Grease fitting, Sold in 10 packs



Chrome Wheel Lugs

Fits all 61"-74"-80"-45" 1936-72 (43530-35A)

19227 Set of 5 (chrome)

19226 Set of 5 (black)

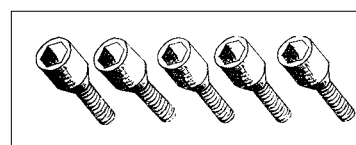

Star Hubs

Completely assembled and includes all internal parts for front and rear.

PCP	Year	Finish
43075	1936-40	Parkerized (3958-36)
43073	1936-40	Black (3958-36)
2511	1941-66	Chrome (43546-36)
43074	1941-66	Black (43540-36)

Chrome Star Hub with Timken-Style Bearings

Complete star hub assembly for 1936-66 BT.

71000



Brake Drum Wheel Mounting Socket Screws

Colony reproduction of OEM 4026-35S bolts. Hardened and parkerized oversized bolts for use on all models 1938-72. 7/16-20 thread.

72466

Wheels and Hubs



Star Hub Cover Kit for 1936-66

This kit includes inner star, grease fitting, and outer chrome or parkerized star. Use as update on early star wheels 1936-66.

PCP Finish

27179 Chrome

43076 Parkerized

43077 Parkerized (no fitting)

79147 Star gasket (10 pk) (43576-35)

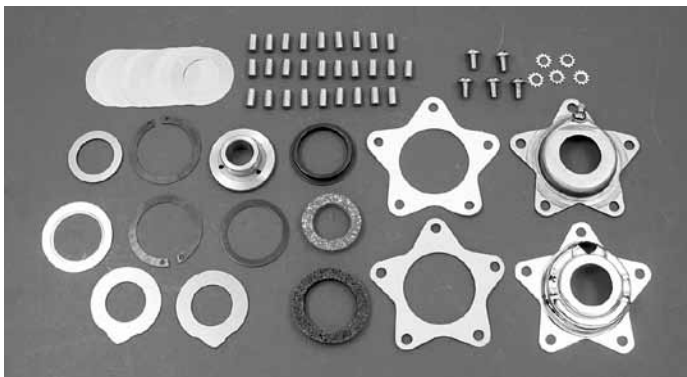

Deluxe Star Hub Rebuild Kit 1936-66

Fits 1936-66 interchangeable hubs. Includes inner and outer stars, screws, gaskets, thrust washers, outer bearing sleeve, snap rings, cork retainer washer and standard rollers.

43080



Internal Star Hub Component Kit

Includes internal rebuilding parts to assemble a bare hub. Includes standard rollers, order oversize rollers separately if needed. Does not include hub. Fits all interchangeable wheels 1941-66.

PCP Model Finish

43078 1955-66 Chrome

43079 1941-54 Parkerized



Star Hub Cover With Hole

44019 1955-66 (chrome)



1936-66 BT Star Hub Wheel Assembly 1936-66

Wheel fits BT 1936-66. Stock replica wheel hub comes with loose type roller bearings and replaces 43540-36. Includes installed rubber rim strip.

Spokes Finish		Size	Width	Hub	Rim	Type
Chrome	Stainless					
70755	70756	16"	3.00"	Chrome	Chrome	F/R
70757	70758	16"	3.00"	Black	Chrome	F/R
	70759	16"	3.00"	Black	Black	F/R
70778	70779	18"	2.15"	Chrome	Chrome	F/R
70780	70781	18"	2.15"	Black	Chrome	F/R
	70789	18"	2.15"	Black	Black	F/R
70782		19"	2.15"	Black	Chrome	F/R
	70786	19"	2.15"	Black	Black	F/R
70767		21"	2.15"	Chrome	Chrome Drop center	F
70768		21"	3.25"	Chrome	Chrome	
70785		23"	3.00"	Black	Chrome	F



70787

Replica Wheel Assemblies

Includes the black step style hub for 1936-40 models.

PCP	Size	Width	Hub	Rim
70787	18"	2.15"	Black	Black
70788	16"	3"	Black	Black



Star Shaped Wheel Hub Outer Cover Screw Kit

Contains 5 head screws and 5 stainless steel lockwashers. Fits OHV Big Twin Harleys 1936-66.

Stock			Acorn	Cap
Chrome	Cad	Parkerized	Chrome	Chrome
1166	8201	9670	1719	3100

1967-72 BT Wire Wheels

6292



70761



1967-72 FL Stock Style Wheel Assembly

Chrome complete laced and trued wheel assembly. Includes lock, screw, seal spacer, tube spacer and one bearing.

Spokes Finish		Size	Width	Type
Chrome	Stainless			
70760	70761	16"	3.50"	Front or Rear FL, 71-72 FX rear only
6292		19"	1.85"	FL Front



1967-72 FL Stock Style Wheel Assembly

Chrome laced and trued wheel assembly without hub hardware. Has small tube hole. FL front and rear 1967-72 and FX 71-72 rear only. 16" x 3.5".

70771

6640



6641



Full Hub Cap, Front 8"

Use to dress up glide forks with stock hubs 1947-72 FLH.

6640 1949-66 Hub cap

6641 1967-72 Hub cap

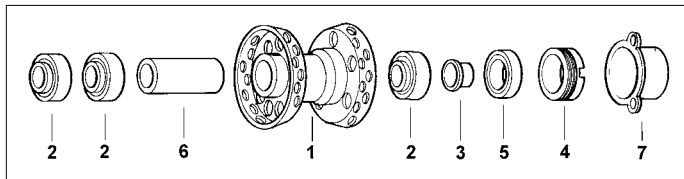

74 Wheel Parts 1967-72

- | PCP | Description |
|-----------|---|
| 1 2335 | Chrome 74 hub (complete) (43540-67A) |
| 43071 | Chrome hub (bare) |
| 43072 | Black hub (bare) |
| 2 15733 | Bearing (43577-67) |
| 3 2525 | Wheel hub spacer (41196-55) |
| 4 12573 | Wheel hub lock nut (43542-67) |
| 5 14057 | Wheel hub seal (41210-55) (5 pack) |
| 6 2526 | FX Axle wheel bearing spacer (43549-67) |
| 7 3590 | Chrome wheel bearing lock nut retainer cover. Fits FL, FX rear 1967-72; FL front 1967-71 (43592-70) |
| N/A 16277 | Lock nut and seal kit |
| 72847 | Cad Locknut & seal kit, Colony |



Internal Bearing & Hardware Kit BT 1967-72

For 1967-72 front and rear hubs. Includes all parts necessary to build or rebuild a bare hub. Includes 3 bearings, tube spacer, seal, seal sleeve & hub lock (LH thread).

5749 Kit



Wheel Lugs

Fit all 61"-74"-80"-45" 1936-72. Replaces OEM 43530-35A. Set of 5.

19227 Chrome

19226 Black

72466 Parkerized, Colony





6807

1980-83 FXWG Wheel Assembly

For dual disc with 41mm forks and 5/16" rotor mount holes. Includes installed internal bearings

Spokes Finish		Size	Width	Hub	Rim
Chrome	Stainless				
6806	6807	16"	3.00"	Chrome	Chrome
	6808	21"	2.15"	Chrome	Chrome



Deluxe Rear Hub Rebuild Kit

For all FX-FL rear hubs 1973-82. Includes all internal parts, including longest length inner spacer (white 4.448"). Spacer may be cut down to shorten length for proper fitting on some applications. Genuine Timken Bearings supplied.

5745 Kit



Chrome Wheel Assembly BT 1973-84

16" x 3.0" Wheel assembly is laced and trued with bearing installed. Assembly includes a drilled steel rotor, chrome 51T sprocket and chrome mounting bolts for each.

PCP Rotor Size
70820 10"



Stock Wire Wheel Assembly

1973-84-FX-FL type, chrome steel hub laced and trued with all new chrome components.

PCP	Diameter	Rim Width
6283	16" Front and rear with chrome spokes	3.0"
6284	As above with stainless steel spokes	3.0"
6285	19" Front	1.85"
6286	19" OEM Front drop centre rim	2.50"
6287	21" Front for 5/16" holes (43664-80B)	1.85"

1980-83 FXWG

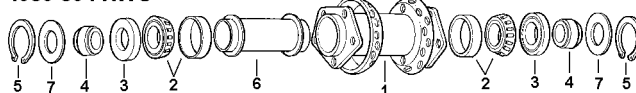

1973-84 FL

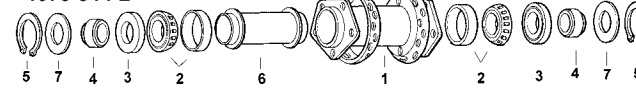

FL Wheel Hub Parts 1973-84

PCP	Description
1 53001	Chrome comp. BT hub FL 1973-84 (43540-73)
5049	Chrome comp. hub FXWG 1980-83 2 Flange (5/16 brake holes) (43663-80A)
2 15504	Bearing and race 1973-99 (9052)
3 14067	Wheel seal 1973-82 (47519-58) (10 Pack)
14069	Wheel seal 1983-99 (47519-83A) (10 Pack)
4 2355	Wheel spacer FL's front & rear 1973-on FX's rear 1973-84 (41196-73)
5 11015	Wheel hub snap ring 1973-82 (11027) (10 pack)
6 2529	Wheel bearing spacer 1973-on orange 4.420 (43601-73)
2530	Wheel bearing spacer 1973-on yellow 4.434 (43602-73)
2531	Wheel bearing spacer 1973-on white 4.448 (43603-73)
7 3304	Wheel hub washer FX rear 1973-on (43559-73)

FLT 1980-81 Rear Wheel Needle Bearing

15612 Replaces 9116



XL Rear Wheels



XL Complete Stock Wheel Assembly

Replacement drum brake type XL rear wheel assembly. Laced and trued with new components. Use on all 1960-78 XL's. Chrome plated.

With Internals

PCP	Size
6127	16" x 3.0"

Late XL Rear Wheel Assembly

16" type chrome rear wheel assembly for all 1979-on XL's. Laced and trued with new components. Assembly includes all internals.

PCP	OEM	YEARS
6125	43720-79	1979-81
6126	40951-82	1982-85

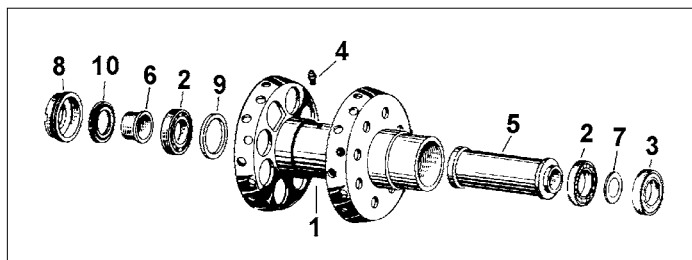

Sportster Rear Wheel Hub Parts 1955-78

PCP	Description
1 2336	Chrome hub only 1955-78 (41017-55C)
2 15712	Wheel bearing unshielded 55-78 (2 used) (9008)
3 15713	Wheel bearing shielded 1955-78 (9009)
4 10511	Grease fitting (9851) (10 pack)
5 3309	Wheel bearing spacer 1963-78 (41185-63)
6 2525	Hub spacer 1955-77 (41196-55)
7 3308	Small spacer washer, brake side 1963-78 (41195-63) (10 pack)
8 12570	Hub lock nut 1955-78 (41201-55)
9 3310	Large wheel bearing spacer washer 1954-78 (41205-52)
10 14057	Wheel hub seal 1955-78 (41210-55) (5 pack)



XLCH-XLH Rear Hub Rebuild Kit

For use on all model steel hubs 1955-78, complete with all parts shown to install in a bare hub.

59507



Late XL Rear Hubs

1982-on Sportster rear hubs. Disc brake type. Chromed with all internals assembled.

53013 XL 1982-85 (40952-82A)

Wide Tire Related



BT Rear Wheel Spacers (BDL)

PCP	Size	BDL
76427	.250"	RPS-0250
76428	.375"	RPS-0375
76429	.500"	RPS-0500
76430	.750"	RPS-0750
76431	.937"	RPS-0937 for use with BDL 1" pulley
76432	1.100"	RPS-1100 for use with CCI wheels
76433	1.250"	RPS-1250



All Balls Wheel Bearing and Seal Kits

Model	Year	Front	Rear
FL	1967-72	43143	43143
FLH, FLT	1982-99	43141	43141
Softail FLS, FXS	1980-99	43141	43141
FX, FXE	1971-72	43145	43143
FX, FXD, FXR	1973-99	43140	43141
FXWG, FXDWG	1980-99	43141	43141
XL	1958-72	43145	
	1958-78		43146
	1979-99	43140	43141



Primary Spacer for Wide Tire Kit

Plain finished spacers fit between the engine and the inner primary when installing a wide tire. The appropriate transmission mounting plate and sprocket shaft extension are required.

PCP	Size
76456	.250"
76457	.500"
76458	.750"
76459	1.00"



Spacer for BT Belt Drive Models 1980-85

This .200 thick spacer will allow the proper spacing between the rear belt pulley and the wheel. It can also be used to install custom wheels on BT and XL models 1983-85.

11855 40932-81

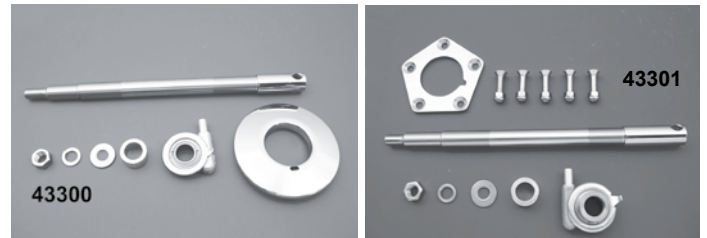

Speedo Drive Adapter Kit 1973-84

FLH kit includes 2:1 ratio speedo drive, chrome hub cover and chrome axle with nuts. FXWG kit includes adapter flange, 2:1 ratio speedo drive and axle.

PCP	Model	Application	Disc	Speedo Drive
43300	FLH	1973-84 spoke hubs 1981-85 cast wheels	Single	Right side
43301	FXWG	1980-83 spoke hubs	Dual	Left side

Hub Parts



Front Wheel Bearing, Race and Seal Kit

Each kit contains two each, bearing, race and proper seals.

PCP Fits:

- 3510** 1980-on FXWG laced wheel
1973-on FLH laced wheel
1980-on FLH cast wheel
- 3511** 1973-79 FLH cast wheel
1973-83 all FX-XL models cast or wire wheel
1982-83 FXR's cast or wire wheel

Late Wheel Seal

Replaces OEM #47519-83A. Used on all 1983-99 models with cast or wire wheels. Sold in 10 packs.

14069 .250"



Wheel Seal

Fits wire wheel FX front 1973-78 except FXWG; XL front 1973-82 XL, rear 1979-82. Fits cast wheels FL front & rear 1973-79; FX front, all models 1974-82; XL front 1974-83; FX rear, all models 1973-82; XL rear 1979-82.

14068 47519-72 (10 packs)



FX-FL Chrome Rear Hub 1973-84

OEM replacement 43540-73. Fits FL, FLH, FX, FXEF, FXEF-80, 1973-84. 3/8" hole disc side, 7/16" hole on brake side.

6625 Chrome without internals

53001 Chrome hub complete



14067

Wheel Seals

Fits wire wheels, FL front & rear 1973-82; FXWG 1980-82; FXs rear 1973-82. Fits cast wheels FL front & rear 1980-82; FLT front & rear 1982; FXWG 1983. Repl. OEM #47519-58.

14067 10 Packs



Flat Mini Hub Caps for Late Model Wheels

Measuring just over 2" in diameter, each one is held in place between the axle or swingarm and the wheel spacer.

Sold each.

PCP Description

- 45318** Fits the front of all FXWG 1980-83 and the rear of all 4-speed BT 1973-84

Chrome FL Front Wheel Hubcaps

A stylish chrome reproduction of FL front wheel 'caps' for laced wheels. Measures a full 8" in diameter

PCP Fits

6642 1973-80 (43304-73)

6643 1981-84 (44463-82)



Front Wheel

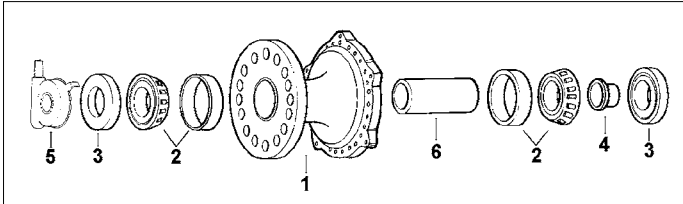

FX & Sportster Front Wheel Parts 1974-77

- | PCP | Description |
|----------|---|
| 1. N/A | Chrome hub assembly FX-XL 1974-77 (43600-74) |
| 2. 15504 | Wheel bearing and race FX-XL 1973-on (9052) |
| 3. 14068 | Wheel seal FX-XL 1973-82 (47519-72) (10 Pack) |
| 4. 2353 | Wheel Spacer FX-XL 1974-77 (43548-74) |
| 5. 2533 | Speedo drive unit XL 1973-79, FX 1973-79 (67127-73) |
| 6. 3737 | Wheel bearing spacer XL 1973-77 (43745-73) |
| 3744 | Wheel bearing spacer FX 1973-77 (43634-74) |

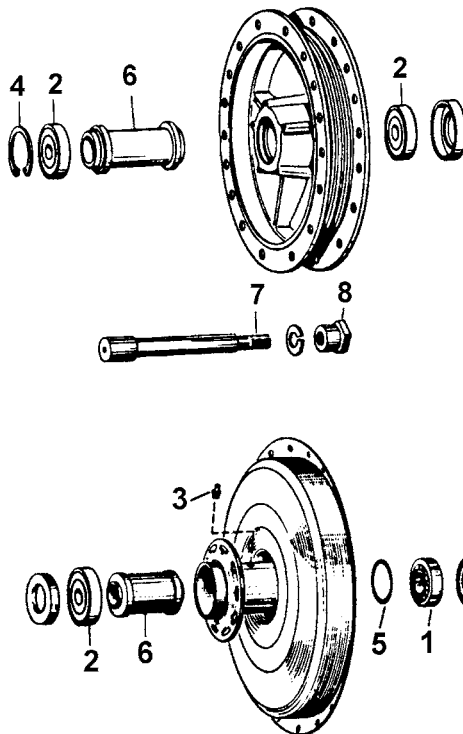

Front Wheel - 1972 and Earlier, XL-FX

- | PCP | Description |
|----------|---|
| 1. 15712 | 1954-63 Front bearing (9008) |
| 2. 15713 | 1954-72 Ball bearing (shielded) (9009) |
| 3. 10511 | 1954-63 Grease fitting (9851) (10 pack) |
| 4. 11017 | 1964-72 Retaining ring (11035) (each) |
| 5. 3310 | 1954-63 Bearing washer (41205-52) |
| 6. 5076 | 1952-72 Wheel bearing spacer (43740-64) |
| 7. 566 | 1952-72 Axle (chromed) (43871-52) |
| 8. 565 | 1952-72, 1970-72 FX Axle nut (43886-52) |



XL-FX Front Wheel Assemblies

Laced and trued front wheels fit with 35mm forks. Comes with all internal bearings installed.

1974-77 XL-FX with single disc and clover type hub.

Chrome Spokes	Size	Width	Hub	Rim
6139	19"	2.50"	Chrome	Chrome Drop center

1978-83 XL-FX with dual disc

Chrome Spokes	Size	Width	Hub	Rim
6142	19"	2.50"	Chrome	Chrome Drop center
6140	21"	2.15"	Chrome	Chrome



21" Chopper Style Wheels

Wheels come in spool or 3" wide mini brake design which includes anchor bar and cable. Both include 5/8" I.D. bearing.

- | PCP | Description |
|-------|--------------------------|
| 70776 | Mini-brake wheel |
| 16099 | Shoes for above |
| 70777 | Spool style wheel |
| 15519 | Bearing for above (each) |

Front Wheel



6142

DD 1978-83 Custom Wire Wheel Assembly

Late dual disc type hub OEM #43600-78. Wheels are laced then trued, with new components. Bearings and internals are included. Fits FX, XL, XLS, FXEF, FXEF-80-82.

PCP	Diameter	Width	Hub
6142**	*19" Front	2.50" OEM	Chrome

***NOTE:** Includes bearings, seals and spacer. Pre-assembled.

** To use on FXR late dual disc models where one piece spacer must be fitted



Late FX-XL Front Wheel 1984-99

Complete front wheel assembly for all 1984-99 FX-XL-FXR's. Laced and trued with all new components. Chrome plated.

6143 19" OEM (drop centre rim) 2.50", 1 or 2 disc

6144 21" Custom with 2.15" rim

The 2.50" OEM rim is the stock factory type 43018-73.



16581



16580

Rear Wheel Spacers

Fits BT 1982-99 models.

16580 4.308" Spacer for wide hub (43608-82)

16581 Spacer washer (43650-82)

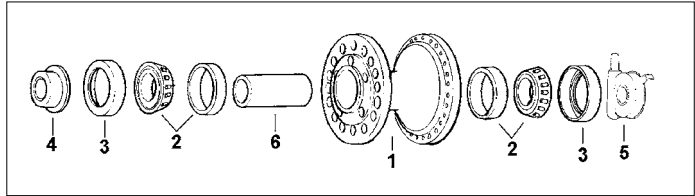

FX & Sportster Front Hub & Parts 1978-on

	PCP	Description
1	2532	Chrome dual disc hub assembly FX, XL 1978-83 (43600-78)
2	15504	Bearing and race FX, XL, 1973-on (9052) (pair)
3	14068	Wheel seal FX-XL 1973-82 (47519-72) (10 pk)
	14069	Wheel seal FX-XL 1983-on (47519-83A) (10 pk)
4	2354	Wheel spacer dual disc FX-XL 1978-83 (43488-77)
	3733	Right side FXWG 1983 (41607-83)
5	2533	Speedo drive unit XL 1973-83, FX 1973-79, 1981-83 (67127-73)
	3306	Speedo drive unit FX models 1980 (not FXWG) (67124-80)
	3722	Speedo drive unit FXR, FXRT, FXSB, FXE-80, XL, XLS, XLX 1984-on (67127-84A)
6	3305	Wheel bearing spacer, violet 2.564" long, FX 1978-on (43623-78)
	3736	Wheel bearing spacer, pink 2.550" long, FX 1978-83 (43624-78)
	3740	Wheel bearing spacer, gold 2.536" long FX 1978-83 (43625-78)



21" Wheel Assemblies

21" wheels give Harleys the late FXST-FXWG look. Available for all years and models, laced and trued, complete with bearings. Ready to install. Rim is 1.85 x 21, not drop centre.

PCP	Application	Type
6287	1973-83 FL-FLH	1 or 2 Disc
6140	1978-82 FX-XL-FXR	2 Disc

Hub Caps



Chrome Hubcaps for 4-Speed FL Models

The perfect accessory for the front wheel of all FXWG from 1980-on, or 1981-84 speed FL models with cast wheels.

45014 4-1/2" diameter hub cap, fitting the cast wheels on FL models 1981-84 (OEM 44443-81).



Chrome Rear Die Cast Hubcaps 1980-on

Allen type, features counter bored holes with socket head screws. Front attaches by 2 screws on FXWG, rear attaches by 5 Pulley Allen Screws, included. Rear fits cast or solid wheel on 1980-on with belt drive.

45017

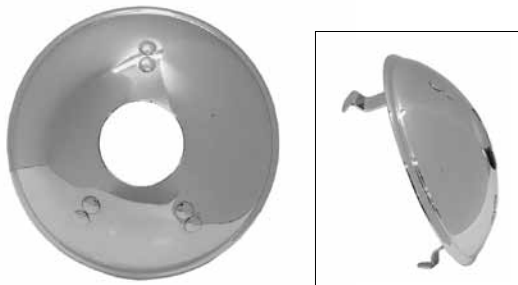

Nostalgic Style Hub Caps

OEM replacement #11260-46. Fits all "74", "80" models 36-1973, front & rear. Chrome plated snaps on with three prong mounts. Excellent for restoration.

2211

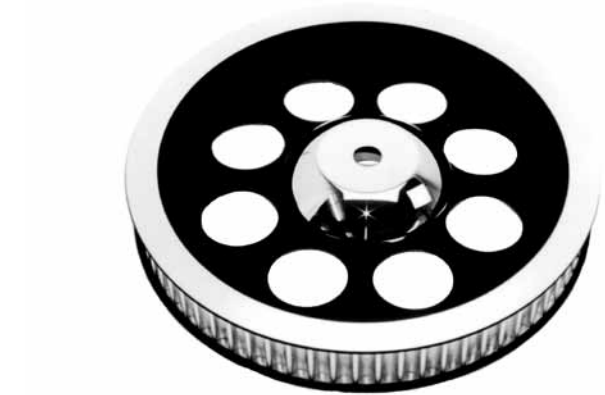

Chrome Rear Hubcap for Belt Drive Models

Accessorize rear pulley area of all BT belt drive models while hiding the stock mounting hardware. Held in place between the axle spacer and swingarm. 4-1/2" hub cap looks great with stock pulleys but better yet when installed with PCP chrome inserts and belt guard.

45015 Fits all BT models with rear belt drive 1980-on

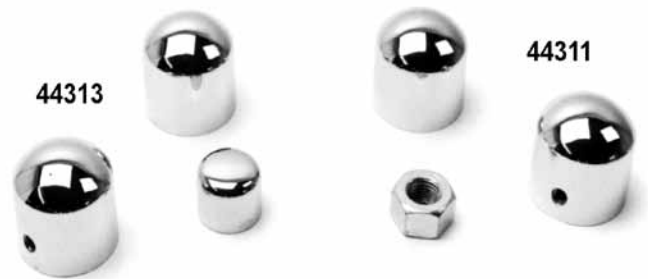

Chrome Allen Cap Kits

Each kit contains the necessary number of chrome axle caps required for your application.

Front

PCP	Description
44313	3 Pieces FL 1949-71
44311	2 Pieces FL 1972-88, FXWG 1980-94,
44310	1 Piece FL/FLT 1973-80, FX 4 speed (except FXWG) 1981-85, FXR 1982-87 (not FXLR or Sport Edition), XL 1973-87

Rear

PCP	Description
44314	2 Piece FL/ FLT 1973-80, XL 1957-80, FX 4 speed 1973-80, FXWG 1980-81
44315	2 Piece FL 4 speed 1981-88, FX 4 speed 1981-85, FXR 1982-88, XL 1981-88, FXWG 1982-86, FLH/T 1980-88

Colony Chrome Front Axle Cover

Chrome plated covers add a smooth finished look and are easily installed with a set screw. Sold in sets of 2 to fit FL 1972, FL 4 speed 1973-84, FL, FLHT 1980-on and FXWG 1980-86. Fits most 1/2-20 threaded axles.

72120

Front Axle

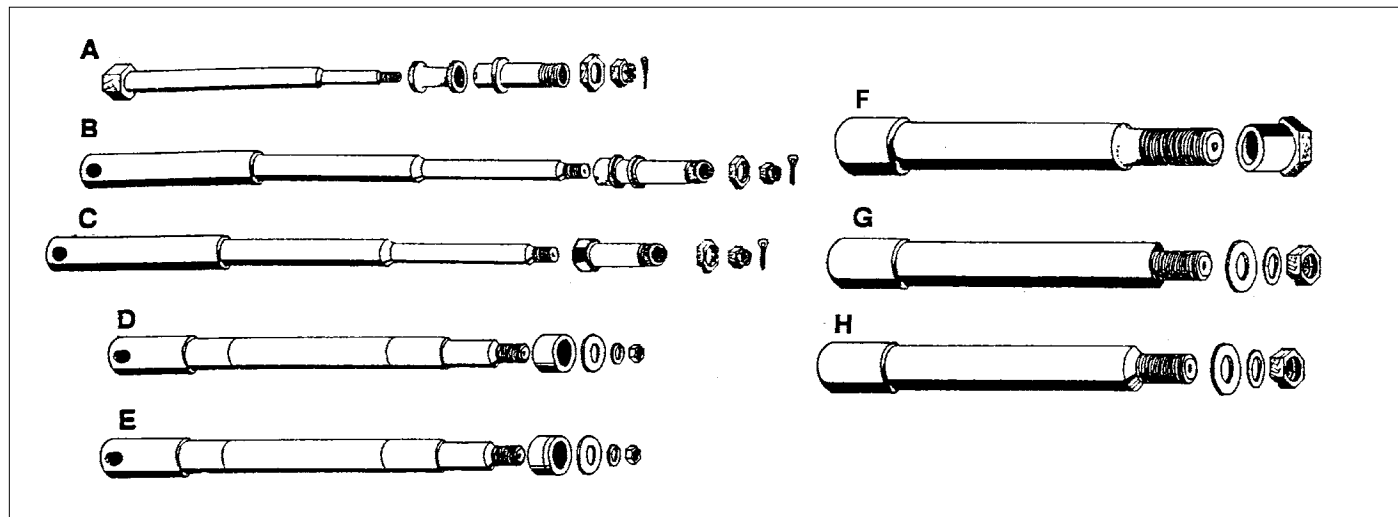

Front Axle Kits

Contain plated axle, nut, spacer, and axle sleeve when required.

#	PCP Kit	Description	PCP Spacer	PCP Nut	PCP Axle	Axle OEM	Finish
A	43322	Springer BT 1936-48 with sleeve	19001	554	3675	43872-36	Chrome
	43323	Black axle as above	19192	9406	19044	(Black)	Black
B	43324	FL Glide 1948-66 with sleeve		554	567	43875-48	Chrome
	43325	Zinc axle as above		5198		43875-48	Zinc
C	43326	FL Glide 1967-71 with sleeve		554	568	43875-67	Chrome
D	43327	FL Glide 1973-80, FXWG 1980-83	2056	5360	569	43875-73	Chrome
E	43328	FLH 1981-85	2056	5360	43321	43867-81	Chrome
F	43330	XL 1952-72, FX 1970-72 (zinc)		565*	566	43871-52	Chrome
G	43331	XL, FX 1973-77		2057	570	43871-73	Chrome
H	43332	XL 1978-83, FXE 1977-83		2057	571	43883-77	Chrome

*Zinc



Chrome Front Axles

Size is measured from inside of head to start of threads

PCP	Fits
3675	EL, FL and UL 1932-47 (9") (43872-36)
567	EL and FL 1948-66 (8 3/16") (43875-48)
568	FL models 1967-71 (9 5/8") (43875-67)
569	4-speed FL 1973-80, and FXWG 1980-83 (9 5/8") (43875-73)
3677	FL 1981-84 (43346-83)
566	Sportster® and K models 1952-72, FX 1971-72 (5 1/8") (43871-52)
570	Sportster® and FX models with single disc brake 1973-77 (6 3/8") (43871-73)
571	Sportster®, FX and FXR models with dual disc brake 1977-83 (7") (43883-77)
3679	Sportster® and FXE with 35mm forks 1984-86 (6 1/2") (43883-84)

FLH Axle Nut

Cad plated stock type front axle nut.
Replaces OEM # 7734W.

12507 Sold each



Stock FL Front Axle

Cadmium plated axle replaces OEM #43875-73. Use on all 1973-80-FL, FLH and 1980-83 FXWG.

5069



Front Axle Nut Kit FL 1949-72 Drum

Kit contains a castle axle nut, a sleeve nut, and a cotter pin.

554 Chrome

5198 Cad

Front Axle Nut & Washer Kit

Chrome washer, hex nut, and stainless steel lockwasher for Harley Wide Glide, FX, or Sportster.

2057 Fits FX, Sportster 1973-79

5360 Fits Wide Glide 1972-on

Rear Axles

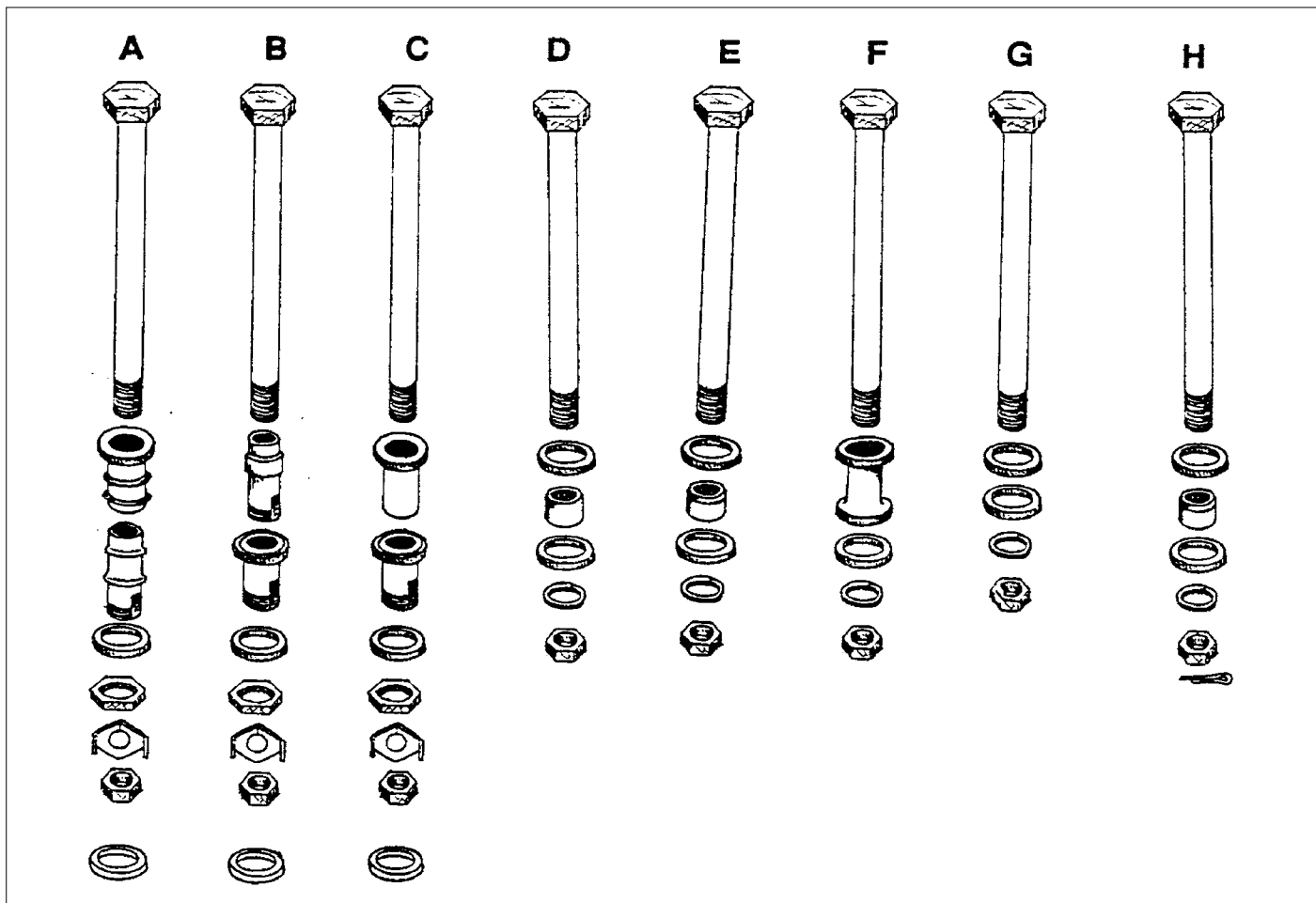

Rear Axle Kits

Kits contain: chrome axle, nuts, sleeves, and spacers for each application. Nut kit includes chrome axle nuts and outer sleeve. Sleeve is included in items A, B, and C.

#	Compl. Kit	Spacer	Sleeve	Nut Kit	Axle	Axle OEM#	Description
A	43340	559	550	555	576	41552-36	Rigid BT 1936-57
A	43341	16577	550		43213	41552-36	As above, Parkerized
A	43342	16578	19023	9688	3681	41551-41	45" Solo 1941-52, black
A	43343	19057	19023	19008	43214	41551-41	As above, chrome
B	43344	560	551	555	575	41552-58A	FL, BT 1958-62
B	43345	560	552	555	575	41552-58A	FL, BT 1963-66
C	43346	561	553	555	574	41552-67	FX-FL 1967-72
D	43347			5306	2052	41552-73	FX-FL 1973-85, FXWG 1980-83
E	43348	16571		5306	3683	41580-79	FL1982-84, FX 1980-86 4 speed w/rear belt
F	43349	563		2057	577	41551-52	XL 1952-78
G	43350			5306	5072	41563-77	XL 1979-87
H	43352	16572		5306	5071	41110-79A	FXR 1982-94

Note: 43345 45 Kit has OEM finish axle with parkerized nuts and black spacer
 43344 Includes side plate spacer # 556 (41596-58)
 43345 Includes side plate spacer # 557 (41596-63)
 43346 Includes side plate spacer # 557 (41596-63)

Rear Axle



Chrome Rear Axles

Size is measured from inside head to start of threads

PCP	Fitment
3681	45" 1935-52 Black (9 1/4") (41551-41)
576	EL, FL, UL 1936-57 (9 5/8") (41552-36)
575	FL 1958-66 (10") (41552-58A)
574	FL, 1967-72, FX 1971-72 (10 1/8") (41552-67)
2052	FL, FLH, FX 1973-85 (10 7/8") with rear chain drive (41552-73)
3683	FL, FX, with belt 1980-86 (11 1/4") (41580-79)
5071	FXR models 1982-on (except 83-84 FXRT), FLT 1980-on (11 3/8") (41110-79A)
577	Sportster 1952-78 (41551-52)
5072	Sportster 1979-87 (10 1/4") (41563-77)



Rear Axle Nut and Lock Kit

Rear axle kit contains 1 each of the following: sleeve nut, sleeve collar, axle nut, and axle nut lockwasher.

555	BT 1936-72 chrome
5197	As above, cad
19008	45 Solo 1941-52 chrome
19009	As above, cad
9688	As above, black
9610	VL 1930-36 chrome
9611	As above, parkerized

Rear Axle Nut & Washer Kit

Chrome plated heavy duty machined steel washers prevent distortion of square swingarms on all Big Twins 1973-on and Sportster 1979-on.

5306 Kit



Rigid Frame Disc Brake Rear Axle

For use when 1973-on rear disc brake units are installed on rigid frames. Kit includes .750 diameter axle, nut, special spacer and washers. Other axles sold separately. Spacers may have to be cut to length. Length of axle includes threads.

PCP	Item	Length	Type
3687	Kit	10.5"	BT rigid chain, XL
43318	Axle	12"	Rigid with belt
3689	Axle	11.5"	Rigid chain
43313	Axle	12.5"	Rigid frame w. disc brake
43317	Axle	12.5"	As above for Swingarm
5073	Collar	1-5/16"	Long (pair)
43104	Collar	1-13/16"	Long (each)
43106	Collar	2 3/4"	Long (each)

5074



Rear Axle Parts

Chrome plated Harley rear axle nut and washers. Harley FL, FLH 1972-79, FX, FXE, FXS 1973-79. Replaces 7986, 7022, 6653 Sportster 1952-79.

2057	Kit
5074	Chrome nut 5/8-18 (5 pack)



Colony Rear Axle Nut Kits

Mounting kits for the rear axle on Big Twin models 1973-88, and Sportster® models 1979-88. Available in acorn or custom cap-nut style.

5278	Acorn style
5279	Cap-nut style

Axle Sleeves



Front Axle Sleeve

PCP	Fits
564	Brake side EL, FL, FLH 1949-66 (43882-48)
562	BT FL 1967-71 (43882-67)
19000	Springer 1936-47 (43882-36)



Front Axle Spacers (sold Each)

PCP	Right Side Application
19001	BT 1932-47 chrome (43884-36)
3733	FXWG 1983 zinc (41607-83)
PCP	Left Side Application
2056	FL, FLH, FLH-80 1973-86, FXWG Classic 1980-82 left zinc (41594-73)



Front Axle Nut

Zinc plated front axle nut.
Sportster 1952-72 FX, FXE 1970-72.
Replaces 43886-52.
565



Speedo Drive Spacer

Replaces speedo drive on all 1973-on FX-XL-FXR when front wheel drive is omitted.
5068 FX, XL 1973-on



10511



10513



10515

Grease Fittings 5/16 x 32 Thread

PCP	Description
10511	Zinc 1938-on (9851) (10 pack)
10513	Zinc, angle 1938-on (9852) (5 pack)
10515	Zinc 1979-84 (25715-47) (10 pack)



Rear Axle Sleeve

For mechanical and hydraulic rear brake backing plate. Plain finish.

PCP	Fits
550	61", 74", 80" 1936-57 (41600-36)
551	FL, FLH 1958-62 (41600-58)
552	FL, FLH 1963-66 (41600-63)
553	FL, FLH 1967-72, FX 1971-72 (41600-67)
19023	45", 1941-52. 45 Solo (41718-41)



Rear Axle Spacer (Outer)

PCP	Fits
19057	All 45's left 1935-52 parkerized (41593-38)
563	Sportster left side 1952-78 chrome (41600-55)
559	61, 74, 80 BT 1936-57 chrome (41595-36)
560	All BT 1958-66 chrome (41595-58)
561	FL 1967-72, FX 1971-72 zinc (41595-67)
2053	All FL left cast/wire 1973-82, FX, FXE, FXEF/-80, FXWG left wire wheel 1973-83, FXE-80 wire 81-86, FX cast 1973-86 zinc (41595-73)
16571	1982 Classic only, FLH-80 1982-84 cast or wire, FXB, FXSB 1980-86 cast wheel zinc (41592-79)
16572	FXR 1981-91 left side cast or wire wheel (41591-81)



Wheel Hub Inner Bearing Spacer Tube

Available for all 1935-up Twins.

PCP	Fits
1307	1936-66 front & rear FL (43549-36)
2526	1967-72 front & rear FL 1971-72 FX rear only (43549-67)
5076	1971-72 FX, 1954-72 XL front (43740-64)
3744	1973-77 FX, XL 2.177" long, front only (43634-74)
3305	1978-on FX, XL front only 2.564" long (43623-78)
2531	1973-on FL front & rear 1973-on rear all FX models 1980-on FXWG front 1982-on XL rear (43603-73)
3309	1963-78 XL rear only (41185-63)

Axle Spacers



Chrome Axle Spacers

Sold each.

PCP	OEM	ID	Length	PCP	OEM	ID	Length	PCP	OEM	ID	Length
43002	43617-95	.750	.930	43011	41595-73	.750	.830	43019	40910-00	.740	.900
43003	40915-94	.720	1.253	43012	41592-79	.745	1.210	43020	41595-00	.750	1.980
43004	43674-95	.725	1.412	43013	41595-86	.745	.1225	43021	43683-00	.740	.990
43005	43683-97	.730	1.350	43014	41607-83	.735	.510	43022	43654-00	.750	.470
43006	41591-90	.740	1.435	43015	47517-58	.745	.380	43023	43617-00	.750	.520
43007	43654-86A	.750	.750	43016	41591-81	.710	.1.265	43026	43613-00	.755	3.040 (raw)
43008	40910-84A	.750	1.255	43017	43648-86	.735	1.370	43025	43608-00	.745	4.810 (raw)
43009	43358-83A	.750	.370	43018	43657-89	.725	.1.030	43024	43517-00	1.00	4.810 (raw)
43010	41594-73	.745	.655								



Rear Axle Seal Spacers 1973-on (Sold Each)

PCP	Application
2355	1979-81 XL Right side only cast or wire wheel, 1973-82 FX, FXE FXEF, FXEF-80, FXE-80, FLH cast wire wheel (41196-73) (pair)
5063	1982-86 FXR cast or wire wheel, 1982-85 XL left side only cast or wire wheel, 1982-86 FXWG wire wheel, 1982-only FXS-80, wire wheel 1982-86 FXB, FXSB wheel (40906-82)
5064	1979-81 Left side only cast /wire wheel (41202-79)
3517	1983-86 FLH-80 cast/wire wheel (41196-83)
5066	E1979-81 XL, XLCH, XLS outer right cast wheel 1-1/2" (41203-79)



Collar, Axle Sleeve

Chrome plated Harley rear axle sleeve collar.

PCP	Fits
558	61", 74", 80" 1936-72, FX 1971-72 (41596-30)
2054	Sportster 1952-77 (41598-52)

Brake Drum Side Plate Spacer

Axle sleeve side spacer. Left side of swing arm

PCP	Fits
556	FL, FLH 1958-62 (41596-58) chrome
557	FL, FLH 1963-72, FX 1971-72 (41596-63) zinc

